

Bentley:

Audi > C4 > 1992 - 1998
Body Exterior, Interior
60 - Sunroof

Sunroof, assembly

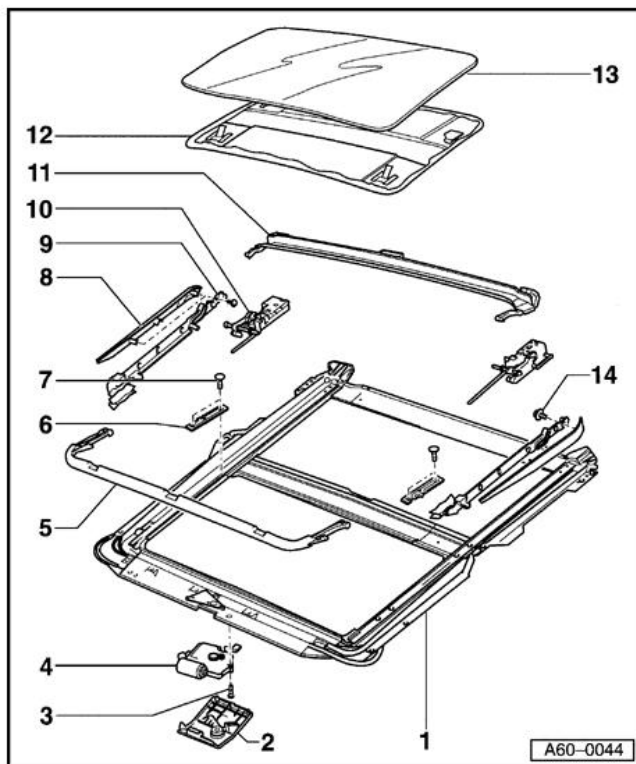

1 - Frame

♦ Removing and installing only possible with headliner removed => page [70-37](#)

♦ Removing => page [60-22](#)

2 - Cover

♦ Removing => page [60-19](#)

3 - Screw and washer assembly (3x)

♦ 3 Nm (27 in. lb)

4 - Sunroof motor

♦ Remove and install in zero position only

5 - Wind deflector

♦ Removing => page [60-24](#)

6 - Guide profile

♦ Remove to remove guide plate

7 - Countersunk screw (3x)

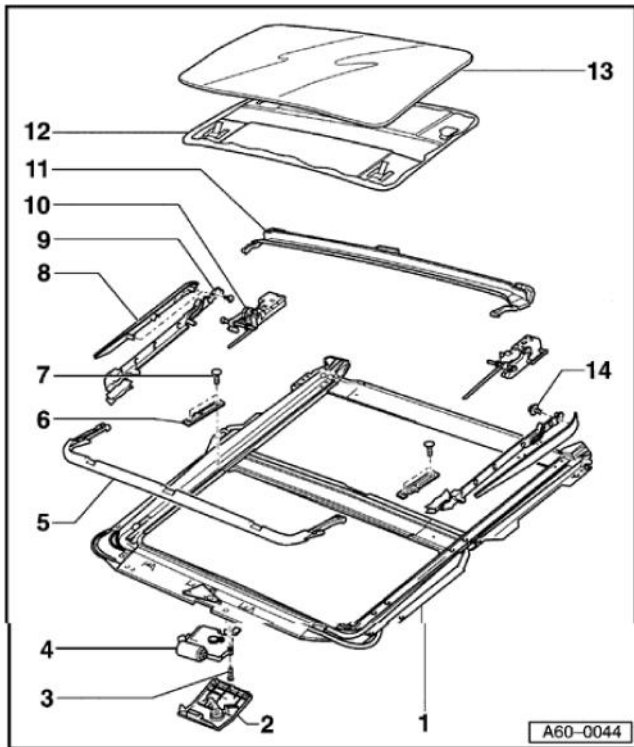

♦ 2 Nm (18 in. lb)

8 - Trim

♦ To adjust, tilt sunroof panel and press trim upward to contact sunroof panel seal and tighten bolts -14-

♦ 1.0 Nm (9 in. lb)

9 - Guide plate

♦ Removing => page [60-26](#)

10 - Rear guide with cable

♦ Removing: remove sunroof panel and guide profile -6-

11 - Water channel

♦ Removing => page [60-25](#)

12 - Sliding headliner

♦ Removing => page [60-31](#)

13 - Sunroof panel

14 - Oval head screw

♦ 1.0 Nm (9 in. lb)

Audi > C4 > 1992 - 1998

Body Exterior, Interior

60 - Sunroof

Sunroof glass panel, assembly

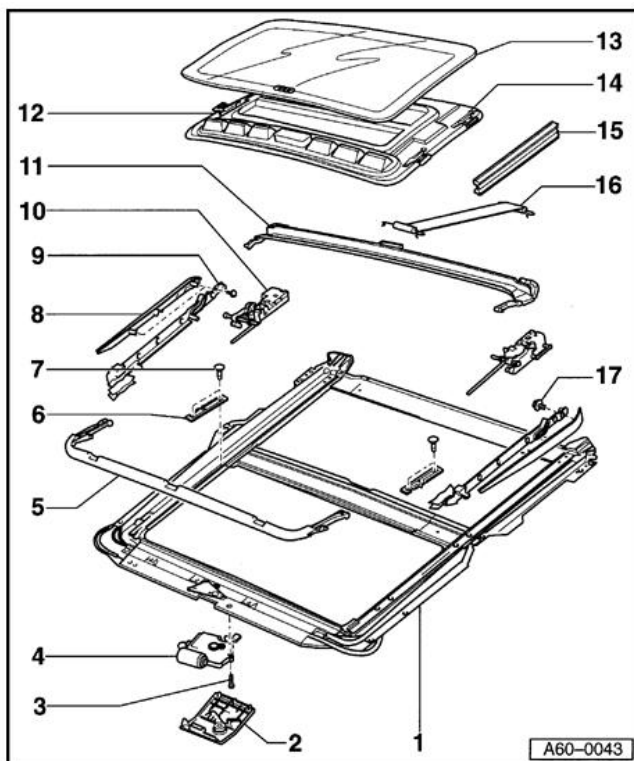

1 - Frame

♦ Removing and installing only possible with headliner removed => page [70-37](#)

♦ Removing => page [60-22](#)

2 - Cover

3 - Screw and washer assembly (3x)

♦ 3 Nm (27 in. lb)

4 - Sunroof motor

♦ Remove and install in zero position only

5 - Wind deflector

♦ Removing => page [60-24](#)

6 - Guide profile

♦ Remove to remove guide plate

7 - Countersunk screw (3x)

♦ 2 Nm (18 in. lb)

8 - Trim

♦ To adjust, tilt sunroof glass panel and press trim upward to contact sunroof panel seal and tighten bolts -14-

♦ 1.0 Nm (9 in. lb)

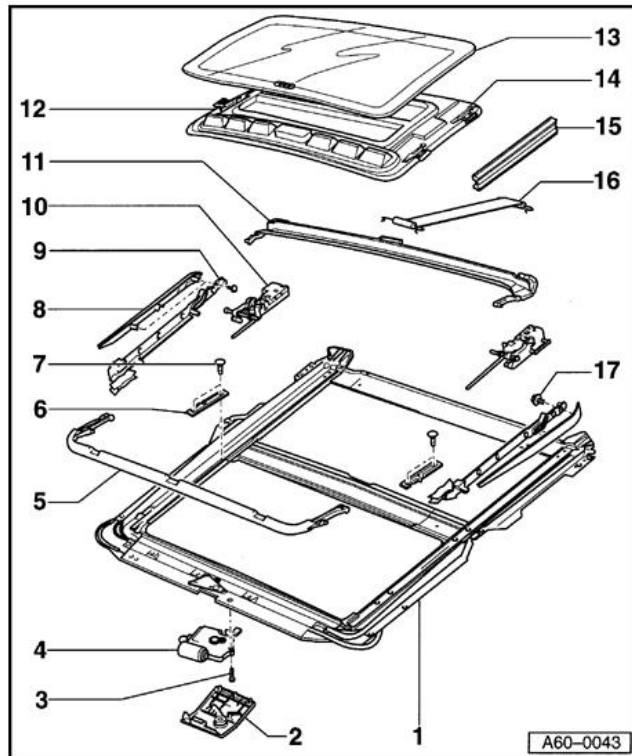

9 - Guide plate

♦ Removing => page [60-26](#)

10 - Rear guide with cable

♦ Removing: remove sunroof glass panel and guide profile -[6-](#)

11 - Water channel

♦ Removing => page [60-25](#)

12 - Sliding headliner

♦ Removing => page [60-31](#)

13 - Sunroof glass panel

♦ Removing => page [60-30](#)

14 - Slide

♦ Pull out to remove from clips on sliding headliner

15 - Trim

♦ Removing => page [60-30](#)

16 - Catch band

♦ No replacement part

♦ Assembly => page [60-31](#)

17 - Oval head screw

♦ 1.0 Nm (9 in. lb)

Audi > C4 > 1992 - 1998
Body Exterior, Interior
60 - Sunroof

Sunroof glass panel, removing and installing

- Drive sliding headliner all the way back.
- Tilt up sunroof glass panel.

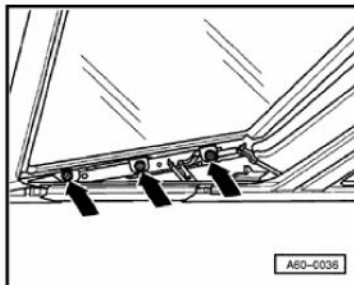
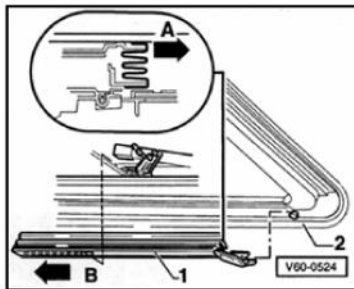

- Pull out trim -1- between sunroof glass panel and sliding headliner in direction shown (arrow -A-).
 - Unclip trim from bolt at front of sunroof glass panel -2- and slide out of clip guide toward rear (arrow -B-).
 - Remove trim toward center of vehicle.
-
- Remove Torx ® bolts (T25) on both sides (arrows) and lift sunroof glass panel off toward top.
- Tightening torque: 4.5 + 0.5 Nm (40 + 4.5 in. lb)
- Adjusting sunroof glass panel => page [60-14](#).

Audi > C4 > 1992 - 1998
Body Exterior, Interior
60 - Sunroof

Sliding headliner, removing and installing

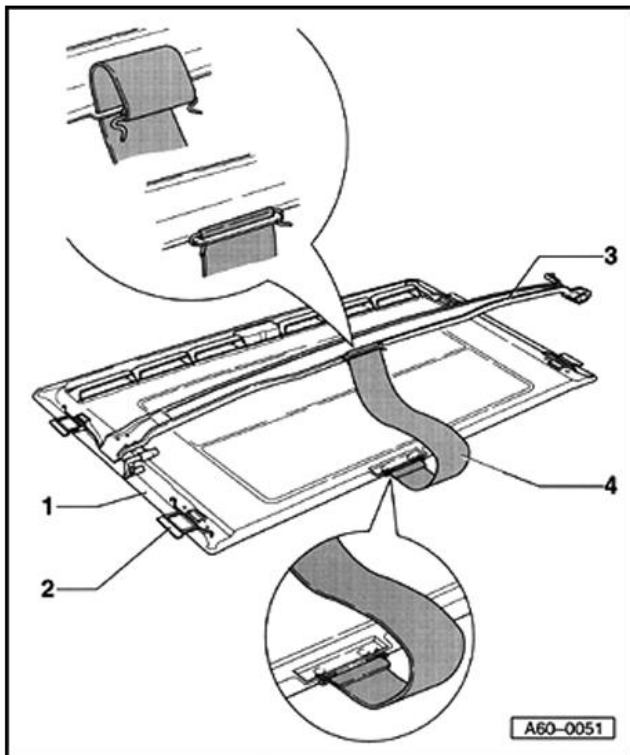

1 - Sliding headliner

- ♦ Sunroof glass panel removed
- ♦ Press out slide on one side toward vehicle center and remove sliding headliner from top

2 - Slide

- ♦ Pull out to remove from clips on sliding headliner

3 - Water channel

- ♦ Removing and installing => page [60-25](#)

4 - Catch band

- ♦ On water channel -3-, slide catch band through eye from below and install spring as shown
- ♦ Install spring on sliding headliner -1-

Audi > C4 > 1992 - 1998
Body Exterior, Interior
60 - Sunroof

Water channel, removing and installing

- Sunroof panel removed

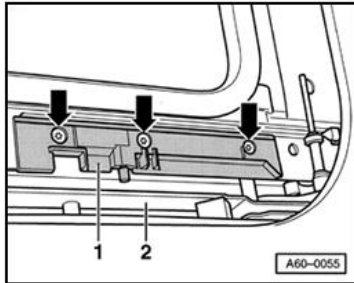

- ◀ - Drive guide plates far enough back until screws (arrows) are accessible.
- Unscrew bolts and remove guide profile -1-.

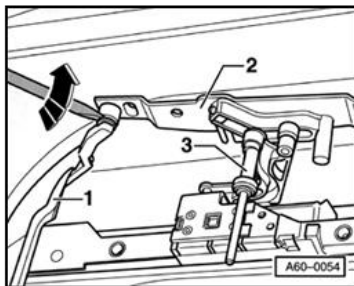

- ◀ - Drive guide plates into "sunroof tilted" position.
- Using screwdriver, pry out water drain -1- from guide plate -2- in direction of arrow.
- Pull water drain forward and out toward top.

Note:

For vehicles with sunroof glass panel, unhook catch on water drain.

Sunroof Panel Removal (92 S4 may not match 95 S6)

↑ Sliding roof panel installed.

Removal:

Open sliding/tilting roof approx. 10 cm towards the rear.

↑ Open retaining clips at left and right -arrows- and push sliding roof headliner towards the rear.

Note:

The fig. shows the retaining clip from the inside of the sliding roof headliner.

60-511

' Wind adhesive tape around retaining clips at left and right so that the clips cannot engage in the sliding roof panel when the roof is tilted.

Note:

When the sliding/tilting roof is tilted, the retaining clips on the sliding roof headliner must not engage in the sliding roof panel as this would mean that the sliding/tilting roof could no longer be closed without damaging the mechanism.

Close sliding/tilting roof; tilt and push headliner forwards.

Press headliner over rain channel and remove towards rear out of the sliding roof opening.

Installation:

60-511

Note:

' Before installing the sliding roof headliner when the sliding roof panel is installed, the retaining clips on the headliner must first be covered with adhesive tape.

Tilt sliding/tilting roof.

Insert headliner through roof opening, push fully forwards into the guides and press over rain channel at rear.

Push headliner towards rear.

Remove adhesive tape.

Close sliding/tilting roof.

Push headliner forwards until retaining clips engage in sliding roof panel

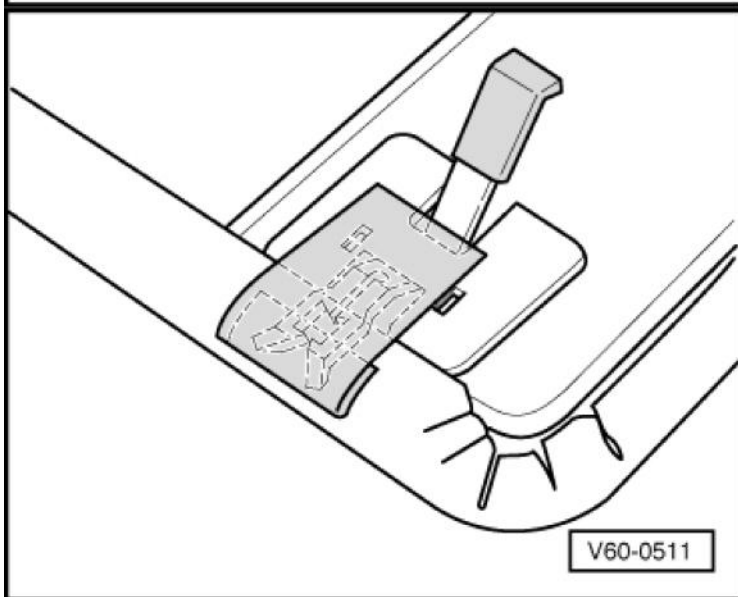
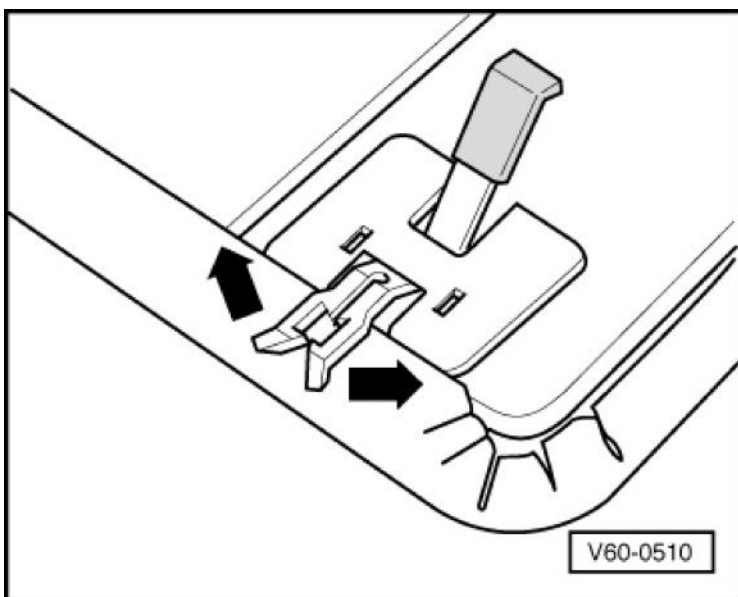

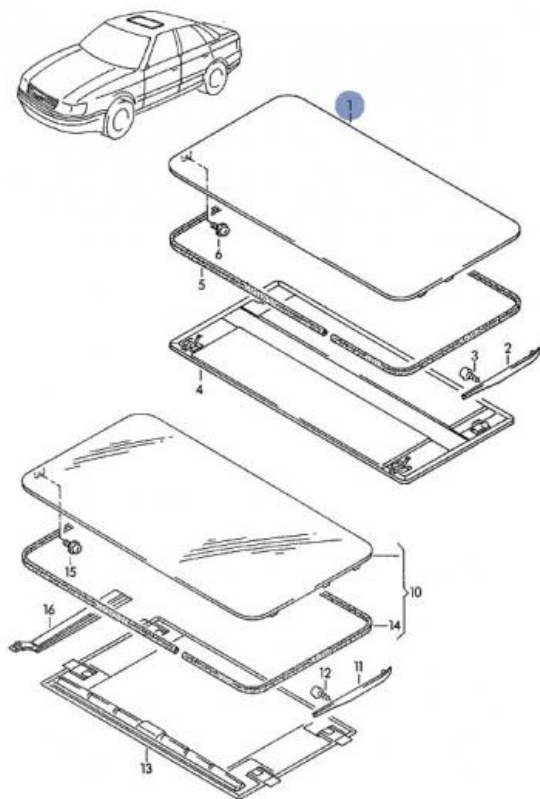

| POS | PART NUMBER | NAME | REMARKS | QTY | MODEL |
|------|-----------------|---|------------|-----|-------|
| | | steel sliding roof | | | |
| 1 | 4A0 877 071 | steel sliding roof panel | | 1 | |
| 2 | 4A0 877 155 | trim | left | 1 | |
| (2) | 4A0 877 156 | trim | right | 1 | |
| 3 | + N 013 958 7 | tapping screw, fill. hd. | ST3,5X13-C | 4 | |
| 4 | 4A0 877 255 B | frame for sliding roof opening with cover | | 1 | |
| | 12/90-07/92 B67 | platinum | | | |
| | 12/90-07/92 P68 | ecru (beige) | | | |
| 5 | 4A0 877 297 G | gasket | 2622MM | 1 | |
| 6 | 895 877 721 A | halbrundsraube (kombi) mit innensechsrund | M5X10 | 6 | |
| - | 321 877 293 | sealing strip | | 2 | |
| | | glass sliding roof | | | |
| 10 | 4A0 877 071 A | glass sliding roof panel | | 1 | |
| 11 | 4A0 877 155 | trim | left | 1 | |
| (11) | 4A0 877 156 | trim | right | 1 | |
| 12 | + N 013 958 7 | tapping screw, fill. hd. | ST3,5X13-C | 4 | |
| 13 | 4A0 877 255 A | sun blind - roof panel | | 1 | |
| | 01/92-07/92 7ZU | ecru (beige) | | | |
| | 01/92-07/92 8ZU | platinum | | | |
| 14 | 4A0 877 297 C | gasket | | 1 | |

Pull knob off - straight down. Pry down rear (switch end) of panel. There are two tabs on the

Posted by: UrS4boy (137) on 2012-08-27 00:15:37

In Reply to: [How to remove the sunroof trim panel on a 92 urs4?](#) posted by baldymcleadfoot on 2012-08-26 20:51:07

side with spring clips. They might break due to age and brittleness.

[Reply](#)
[Share](#) | [Report](#)

DO NOT PRY DOWN FROM THE FRONT. It pivots from the front, based on the three little hooks at the front. See this boxflares

photo:



Draft Sunroof R&R FAQ post, with pictures!- speak now or forever hold your peace.

Posted by: boxflares ([3668](#)) on 2011-12-04 14:17:55

[Reply](#)
[Share](#) | [Report](#)

Tools needed:

- Assorted slotted screwdrivers, 1/4" drive ratchet, 6" extension, and Torx T20 bit. You really need the ratchet for the rearmost screw.



1) Start by tilting the sunroof and pushing the sunshade all the way back.

2) Next, grab the lower rear corner of the "bellows" that hides the hardware, and pull hard towards the center of the car. It should pull loose without too much effort.



3) Push the bellows up out of the way and pull the 3 T20 bolts per side- the one way in the front and the one in the back are the hardest to get at (picture with bolts already out). Don't worry if you drop them during removal- they're easy to retrieve once you pull the sunroof panel. Once all 6 bolts are out, the sunroof just lifts out the top.



4) Once the sunroof is out, you need to remove the sunshade. Slide it forward and remove it by pushing it away from you on the spring loaded guides until the near side guides clear the track. Once the guides are clear, just lift it out.



5) If your rain tray is broken, you may have to fish it out of the carrier. A broken raintray looks like this. The front arms (or

pieces if it's broken) snap in, but should pry out pretty easily. You need to remove both sides. Pull the front first, particularly if it's intact- it will allow you to slide the rain tray further forward and make it a bit easier to get at. Don't use a lot of force- the metal isn't very strong.



6) The rear mounts are harder to get at, and harder to get to release. What I've found works the best is using 2 screwdrivers- one inserted as shown to push the arm out of the mount, the other prying open the slots in the clip. Again, be gentle because the metal isn't very strong. The good news is you only have to release one side. Once the near side is out, push the rain tray away from you and it should just lift out. Make sure you get the nylon guide that sits in the track.



7) This is what the rain tray looks like out of the car. The strap attaches the rain tray to the sunshade so that it pulls forward automatically.

8) Installation is basically the reverse of removal- you should install the rear guides first because again that allows you to pull it a bit further forward so they are easier to access. Once they're in just snap in the front guides.



I'll add that to the writeup before I post it, but JB Weld and some coat hanger.

I was finally able to get the rain tray out and thought someone else might be able to use this information to help them. The trick is that it isn't just an end nut, but more of a bushing that actually runs through the arm. I was unable to push out the arm with a screwdriver, instead I was able to gently pry the bushing off with tiny screwdrivers. The broken arm ends can be worked out gently to be removed. Here is a picture:

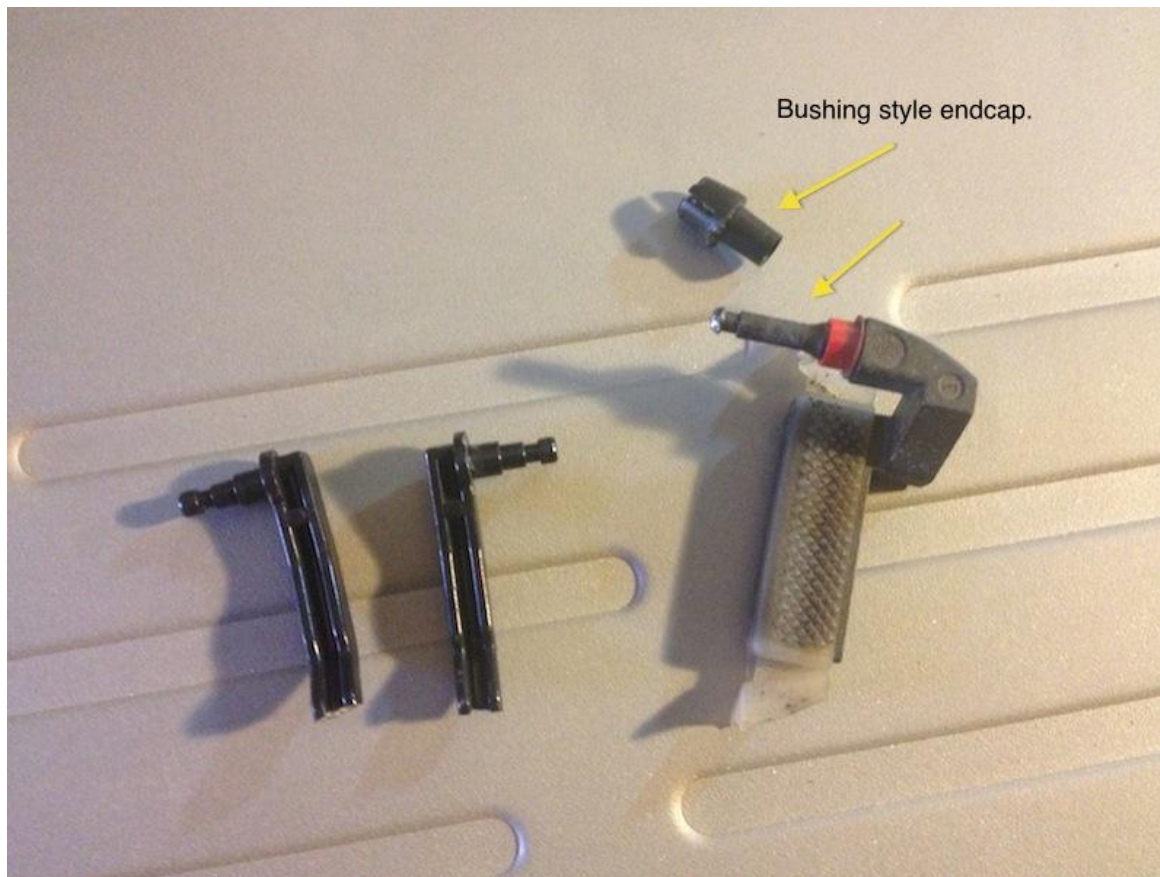

Additionally, I went a little bit further with the wire hanger wire reinforcement. I dremeled out the channel on the rain tray itself so the wire could run the length of the arms.



After modeling the reinforcements and several test fits, the wire literally snaps into and holds the arms together:





And now the epoxy is curing. The electrical tape is just precautionary to keep the arm from falling.



So my question is, once it has dried and looks like this (image credit: islingtonaudi) what is the trick to get the arms back into the sunroof 'trucks'?



Note: Credit goes to various posters on QW & other sites